

Features:

- 8A switching capacity
- Low power consumption, strong anti-shock resistance
- Compact size, PCB mount
- Superior electrical durability and reliability
- Single/Dual coils available
- Environmentally friendly products(Accord RoHS)
- Dimensions: 20.2 mm×11.1mm×10.5 mm

Typical Application:

- Smart home
- Electrical control

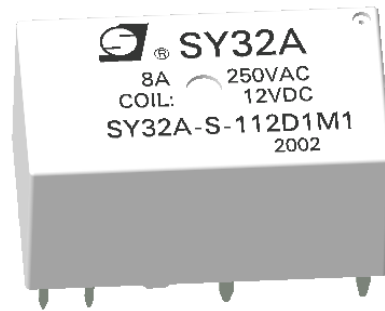

Approvals

CQC (File No.): CQC22002368089

Contact Data

Contact form	1 Form A or 1 Form B
Rated Load	8A 250VAC
Max.switching voltage	250V
Max.switching current	8A
Max.switching power	2,000VA
Contact Material	Silver alloy
Contact resistance	≤100mΩ
Max.Operate/Release time	10ms/10ms
Electrical Endurance	5×10 ⁴ cycles (8A 250VAC Resistive load)
Mechanical Endurance	1×10 ⁷ cycles

Insulation Data

Insulation Resistance	≥1,000MΩ (500VDC)
Dielectric Strength	Contact-Contact AC1,000V; 50/60Hz 1min
	Contact-Coil AC2,000V; 50/60Hz 1min

Outline Dimensions (Unit: mm)

Coil Data

Coil voltage range		5 to 24VDC		
Coil insulation system according UL		Class F		
Coil type, standard type				
Rated	Operate/Rel	Coil resistance	Rated power	Pulse
Voltag	Voltage	Single/Dual	Single/Dual	Duration
VDC	VDC	Ω (1±10%)	W	ms
5	≤4.0	167/83.5	0.15/0.3	≥50
6	≤4.8	240/120	0.15/0.3	≥50
9	≤7.2	540/270	0.15/0.3	≥50
12	≤9.6	960/480	0.15/0.3	≥50
24	≤19.2	3840/1920	0.15/0.3	≥50

All figures are given for coil without pre-energization, at ambient temperature 20°C.

Other Data

Material compliance: EU RoHS/ELV, China RoHS, REACHHS		
Ambient Temperature	-40°C to +85°C	
Ambient Humidity	5% ~ 85% RH	
Vibration resistance	10 ~ 55Hz, 1.5mm DA	
Shock resistance	Durability	100g
	Malfunction	10g
Packaging type	Plastic sealing type	

Type A

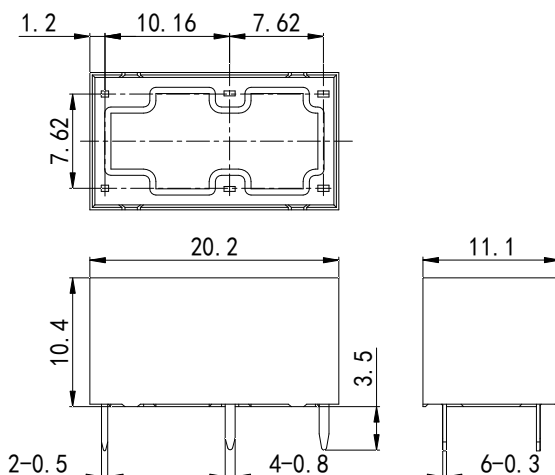

Type B

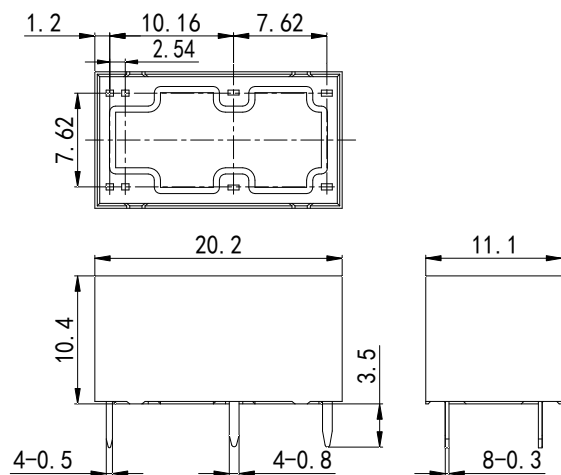

Note: Some product dimensional tolerance is not specified. When < 1mm, the tolerance is ±0.2mm; when between 1~5mm, the tolerance is ±0.3mm; when > 5mm, the tolerance is ±0.4mm.

Wiring Diagrams

Single

Positive polarity	1+	Close	2-
	1-	Open	2+
Reverse polarity	1-	Close	2+
	1+	Open	2-

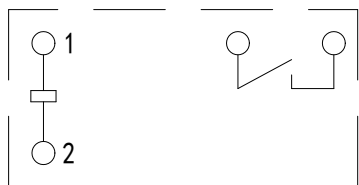

Dual

Positive polarity	1+	Close	2-
	3+	Open	4-
Reverse polarity	1-	Close	2+
	3-	Open	4+

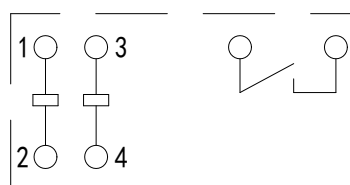

Model naming rules

SY32A	-S	-1	12	D	1M	1	
							Coil type: 1-Single coil; 2-Dual coils
							Contact form: 1M - 1 group of normally open contacts
							Coil Power Consumption: D - Standard Type
							Coil Specifications (VDC): 05 , 06 , 09 , 12 , 24
							Contact groups: 1-1 group
							Packaging type: S-Plastic encapsulation
							Type: SY32A

Customized special suffix is available after being evaluated by Sanyou.

Examples of Ordering Codes

SY32A-S-112D1M1

Relay SY32A, Plastic encapsulation, 1 group of contacts, Rated coil voltage 12VDC, Standard Type, 1 group of normally open contacts, Single coil

Cautions

1. The original position of latching relay is "closed" when shipping. It is possible that during transit or installation, the relay may change its state to be "open" position, it is recommended to set the relay in to state needed via apply voltage to the coil.
2. In order to let relay operate normally, the voltage which apply to the coil should reach to the rated voltage, the pulse width should be 50ms to 100ms Do not energize both coil at the same time on Dual coil or energize the coil for longer than minute.
3. Relay without copper wire, the terminal can not be soldered, bend, and rigid fasten both two terminals.
4. Keep away from corrosive gas and other condition which may damage the relay.

Disclaimer

This product specification is for reference only and may change without prior notice. Customers should select the appropriate product model according to the performance parameter requirements of their specific application areas. The customer will bear the responsibility and loss caused by improper selection. For more technical support, please contact Sanyou Corporation Limited.