

## Product features:

- Excellent resistance frequency characteristics
- Good temperature stability
- High resonant frequency

## Application area:

- Industrial power supply
- Household appliances
- Transportation electrification
- Renewable energy
- Power and infrastructure

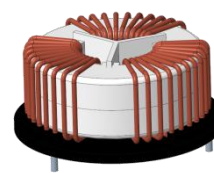

## Basic product parameters

Product Parameter	Rated current	Inductance	Testing conditions	DC resistance (20°C)	Core material	Hi-POT (VAC)	Insulation resistance	Operating temperature
80250201	8A	5mH Min.	1KHz 0.3V	0.26Ω Max.	1K107B	2.0KV 1mA 3s	100MΩ Min.	-25°C~+120°C

## Reference dimension drawing

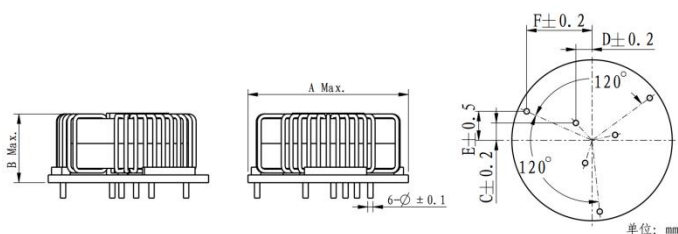

## Recommended installation dimension

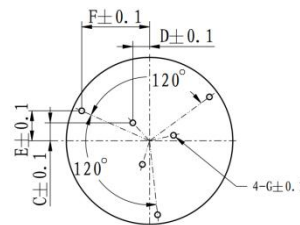

Product Parameter	A	B	C	D	E	F	φ	G
80250201	42.5	22	4.5	4.2	7.5	17	1.30	1.90

Undeclared dimensional tolerance: < 2 mm, ±0.1mm; 2~10mm, ±0.3mm; > 10mm, ±0.5mm

## Product model description

Product series		Product model				Product Parameter		
SL	N	-	X	C	T30	-	802	501
						01		
						Serial number		
						Inductance: 50μH*100=5mH		
						Rated current: 80mA*100=8A		
						The outer dimensions of the ring-shaped iron core		
						Three sets of circular enameled wire winding		
						Core structure: Horizontal type with enclosure		
						Core material: Nanocrystalline		
						Sanyou Plug-in Inductor		

Declaration: This product specification is provided solely for customer reference during use. Any changes will not be notified separately. If you have any questions, please contact Sanyou for more technical support.