

High power relay

SPV75

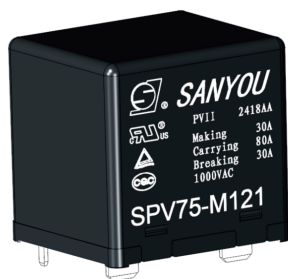

Peculiarity

- High contact capacity: 75A contact switching capability.
- The coil holding voltage can be reduced to 50~55%V of the rated coil voltage to achieve energy saving.
- A set of normally open contacts with contact spacing > 4mm.
- In line with European photovoltaic standards IEC62109、VDE0126.

Safety regulation

- UL/CUL Certification Number: E179745
- TUV certification number: R50632515
- CQC certification Number: CQC24002433093

Contact parameter

Type	SPV75
Rated load (resistance)	75A 1000VAC
Maximum switching current	80A
Maximum switching voltage	1000VAC
Maximum switching power	80,000VA

Performance parameter

Contact material	Silver alloy	
Contact resistance	10mΩ MAX. (6VDC 20A)	
Response time	30msec.Max.	
Releasing time	10msec.Max.	
Insulation resistance	1000MΩ Min. (DC500V)	
Dielectric withstand voltage	Between contact and coil	AC5000V, 50/60Hz 1min.
	Between contacts and contacts	AC2000V, 50/60Hz 1min.
Vibration resistance	Destructive	10 ~ 55Hz, 1.5 mm DA
	Functional	10 ~ 55Hz, 1.5 mm DA
Shock resistance	Destructive	100G Min.
	Functional	10G Min.
Endurance	Mechanical endurance (at 9,000 ops./h)	1,000,000次
	Electrical endurance (at 360 ops./h)	30,000 cycles (30A Making 80A Currying 30A Breaking @85°C) 6,000 cycles (60A 320VAC@85°C)
Relative humidity	-40°C~+85°C(No condensation)	

Unit weight approx 80g

Coil parameter (at20°C)

Nominal voltage (VDC)	Rated current ±10% (mA)	Coil resistance ±10% (Ω)	Max. allowable voltage	Operate voltage (MAX.)	Release voltage (MIN.)	Nominal operating power (w)
12	160	75	110% of nominal voltage	75% of nominal voltage	5% of nominal voltage	1.92W
24	80	300				

Remark: (1)The relay applies full coil voltage to maintain 200ms.

(2)Coil holding voltage is the coil excitation voltage maintained after 200ms, down to 50~55% of the rated coil voltage.

(3)The relay coil is not allowed to apply more than the upper limit of the holding voltage for a long time to prevent the relay from overheating and burning out.

Safety certification load

(Note: For more details on the certification load, refer to the safety certificate)

Certification type	CQC	TUV	UL
Certificate number	CQC24002433093	R50632515	E179745
Authentication load	320VAC 60A 1000VAC 30A/80A/30A	320VAC 60A 1000VAC 30A/80A/30A	320VAC 60A 1000VAC 30A/80A/30A

(1)All values without indicating temperature are tested under room temperature

(2)Only typical ratings are listed above and the endurance differ in each load. Other specific load information are available upon request

(3)For sealed type testing, please open the ventilation hole in the case before test

Ordering Information

SPV	75	- M	12	1	
					Special Requirements: Empty - Standard type, Letters or numbers - Special requirements
					Contact material: 1-AgSnO2
					Coil specification: 12, 24 (VDC)
					Contact arrangement :M - normally open type
					Load type: 75-75A
					Type : SPV

Dimensions, Wiring diagram (Unit:mm)

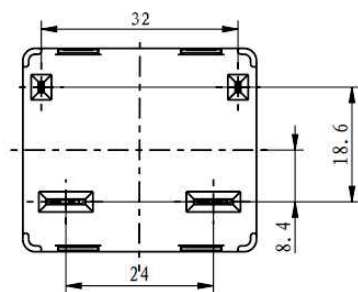
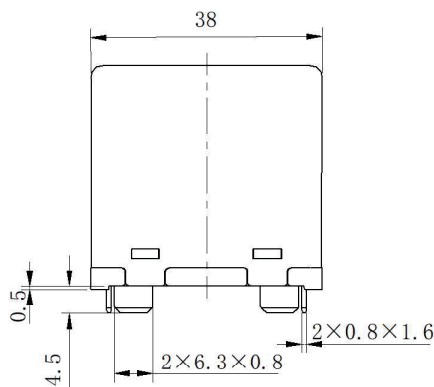

Note: 1. The dimension of pin is the size before tinning
2. Tolerance of PCB. layout: ±0.1mm.

Unless otherwise specified:

If dimension < 1mm, tolerance: ±0.2mm;

If dimension 1~5mm, tolerance: ±0.3mm;

If dimension > 5mm, tolerance: ±0.4mm.

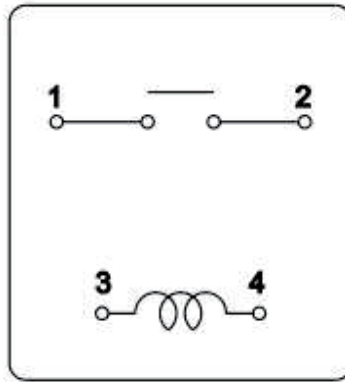

Wiring diagram (bottom view)

Statement:

This product specification is for customer's reference only and is subject to change without prior notice.

For Sanyou, it is not possible to assess all the performance parameter requirements of relays in each specific application field, so customers should choose products that match them according to the specific conditions of use. For sealed relays in After installation and cleaning, open the air holes on the housing before use. If in doubt, please contact Sanyou for more technical support, but the product selection responsibility is the customer's responsibility.

©Sanyou Lianzhong Group Co., LTD. All rights reserved.