

## Feature

- 25A motor rating.
- Microminiature
- Transformational contact
- Single and dual relays available.
- H (180°C)insulation Class
- 250 °C reflow soldering

## Contact Capacity

Model	SARI
Nominal switching capacity (res. load)	25A 14VDC ( at 23°C )
Max. switching current	30A
Max. switching voltage	16VDC

## Characteristic Data

Contact material	Silver alloy	
Dropping Voltage of Contacts	250mv/at 10A (max)	
Operate time (at nominal volt.)	10msec. Max.	
Release time (at nominal volt.)	10msec. Max.	
Initial insulation resistance	500MΩ Min.(DC500V)	
Initial dielectric strength	Between open contacts : AC500V , 50/60Hz 1Min.	
	Between coil and contact :AC500V , 50/60Hz 1Min.	
Vibration resistance	Functional	10 ~ 100Hz , 44.1m/s <sup>2</sup>
	Destructive	10 ~ 500Hz , 44.1m/s <sup>2</sup> 2h
Shock resistance	Functional	100m/s <sup>2</sup> ( pulse duration: 11ms)
	Destructive	1000m/s <sup>2</sup> ( pulse duration: 6ms)
Endurance (operations)	Mechanical (at 10,800 ops./h)	1×10 <sup>7</sup>
	Electrical (at 600 ops./h)	1×10 <sup>5</sup>
Ambient temperature	-40°C ~ +110°C (no condensation)	
Unit weight	Single type : Approx 3.5 g ; Dual type : Approx 6.5g	

## Coil Data(at 20°C)

Nominal voltage (VDC)	Nominal operating current ±10% (mA)	Coil resistance ±10% (Ω)	Max. Allowable voltage (VDC)	Pick-up voltage (Max.) (VDC)	Drop-out voltage (Min.) (VDC)	Nominal operating power (W)
12	75	160	16	≤6.5V	≥0.8	0.9
12	54.3	221	16	≤7.7V	≥0.8	0.65

## Contact Data

Contact Voltage	Rating type		contact rating current(A)		Duty factor		Endurance (cycles)	Material	Test ambient temperature
			1C, 1A		On (S)	Off (S)			
			NO	NC					
14VDC	Resistive Load	On	25	10	1	9	1x10 <sup>5</sup>	AgSnO <sub>2</sub>	23°C
		Off	25	10					
	Motor Load	On	25	—	0.5	0.95	1x10 <sup>5</sup>	AgSnO <sub>2</sub>	
		Off	25	—					

## Ordering Information

Nomenclature						
SARI	-S	-1	12	D	-XX	
						Special Parameter : Nil-Standard type, Letter or number-Special requirement
						Coil Power : D-0.9W, H-0.65W
						Coil Voltage (VDC) : 12
						Number of Poles : 1-single relay 2-dual relay
						Protective Construction : S-Flux proofed ;SH-sealed type washable
						Type Designation : SARI

## Outline Dimensions, Wiring Diagram, Mounting Holes (unit : mm)

Single Relay

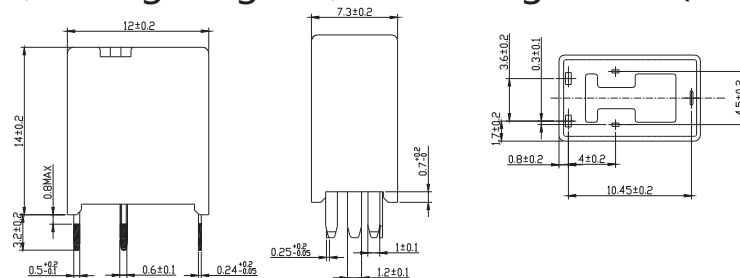

Dual Relay

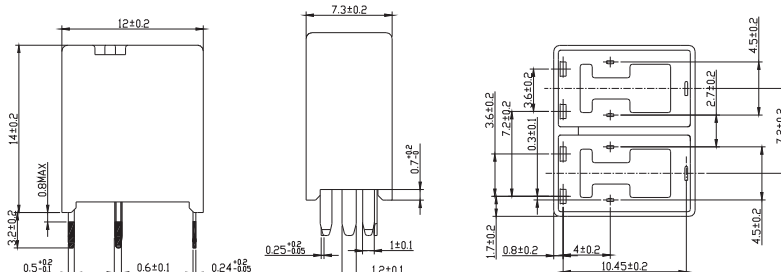

Unless otherwise specified :

If dimension < 1mm, tolerance : ±0.2mm;

If dimension 1~5mm, tolerance : ±0.3mm;

If dimension > 5mm, tolerance : ±0.4mm.

Note : 1. Extended terminal dimension is dimension before soldering.

2. Tolerance of mounting holes : ±0.1mm.

Single Relay

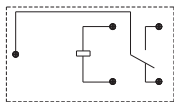

Dual Relay

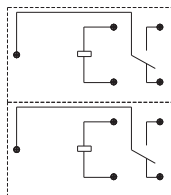

Wiring Diagram (bottom view)

**Disclaimer:**

This datasheet is the customers' reference. All the specification are subject to change without notice.  
We could not evaluate all the performance and all the parameters for every possible application. Thus the user should in a right position to choose the suitable product for their own application. If there is any query, please contact Sanyou for the technical service. However it is the user's responsibility to determine which product should be used only.